

FOR LEASE: INDUSTRIAL SPACE



FEATURES

- LAYOUT: RECEPTION, 2 OFFICES, 3 BUILT-IN CUBICLES, RESTROOM AND EVAP-COOLED WAREHOUSE.
- CLEAR HEIGHT: 13'
- DRIVE IN DOORS: 1
- SPRINKLERS: FULLY
- LOCATION: EAST OF HAYDEN ROAD
- ZONING: CITY OF SCOTTSDALE I-1

Available:

Suite(s) 102 +/-2,060 sf
40% office

Lease Rate:

\$0.85/sf
Industrial Gross

*To see our other properties
follow this link*

<http://www.screaz.com/>

Garden Place Properties

8320 E. Gelding Drive
Scottsdale, AZ 85260

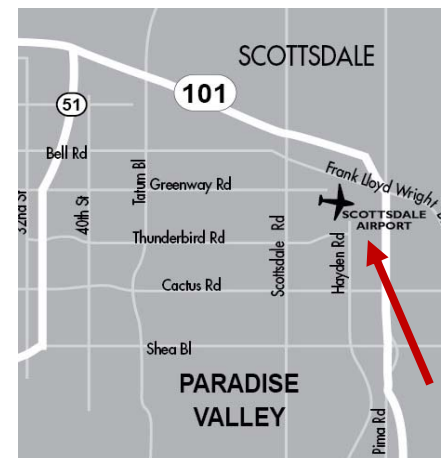

CONTACT:

ERIC SCHAEFER
eric@screaz.com

Cell: (602) 525-0713

7621 E. Gray Rd., Suite D
Scottsdale, AZ 85260

Office: 480.998.5025
Fax: 480.951.2493

FOR LEASE: INDUSTRIAL SPACE FLOOR PLAN



**8320 E. Gelding Drive
Scottsdale, AZ 85260**

Suite(s)

102

Size

+/- 2,060 sf

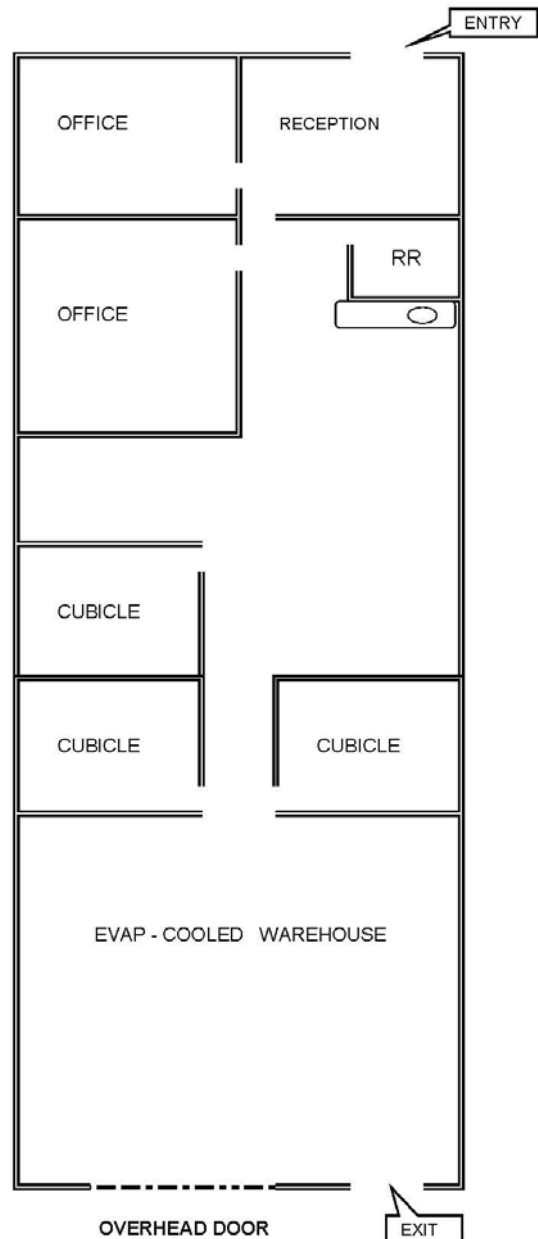

CONTACT:

ERIC SCHAEFER
eric@screaz.com

Cell: (602) 525-0713

**7621 E. Gray Rd., Suite D
Scottsdale, AZ 85260**

Office: 480.998.5025

Fax: 480.951.2493