

FOR SALE: TWO TENANT BUILDING
7652 & 7654 E. ACOMA DRIVE – SCOTTSDALE AIRPARK
C-4 (USE PERMIT FOR AUTOMOTIVE) & I-1 ZONING



- 18,984 SF (10,992 SF C-4 Automotive + 7,992 SF I-1)
 - Present C-4 use is Lotus auto dealership (former Ferrari dealership)
 - Unique/Upscale renovated interior & new roof
 - Owner may facilitate financing
- Price: \$3,990,000**



CONTACT:

DON SCHAEFER
don@screaz.com

Cell: (602) 359.1599

7621 E. Gray Rd., Suite D
Scottsdale, AZ 85260

Office: 480.998.5025
Fax: 480.951.2493

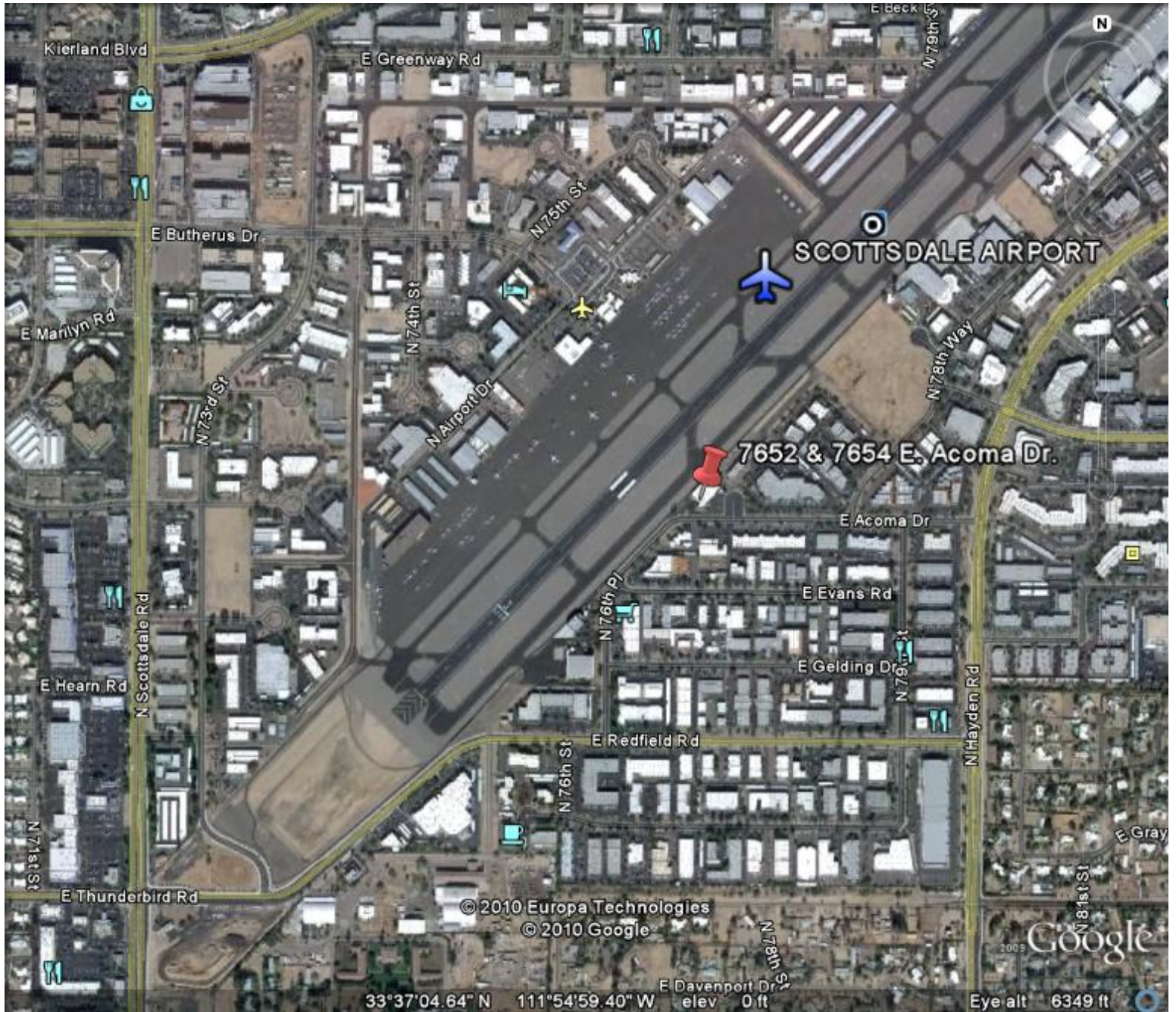

CONTACT:

DON SCHAEFER
don@screaz.com

Cell: (602) 359.1599

7621 E. Gray Rd., Suite D
Scottsdale, AZ 85260

Office: 480.998.5025

Fax: 480.951.2493

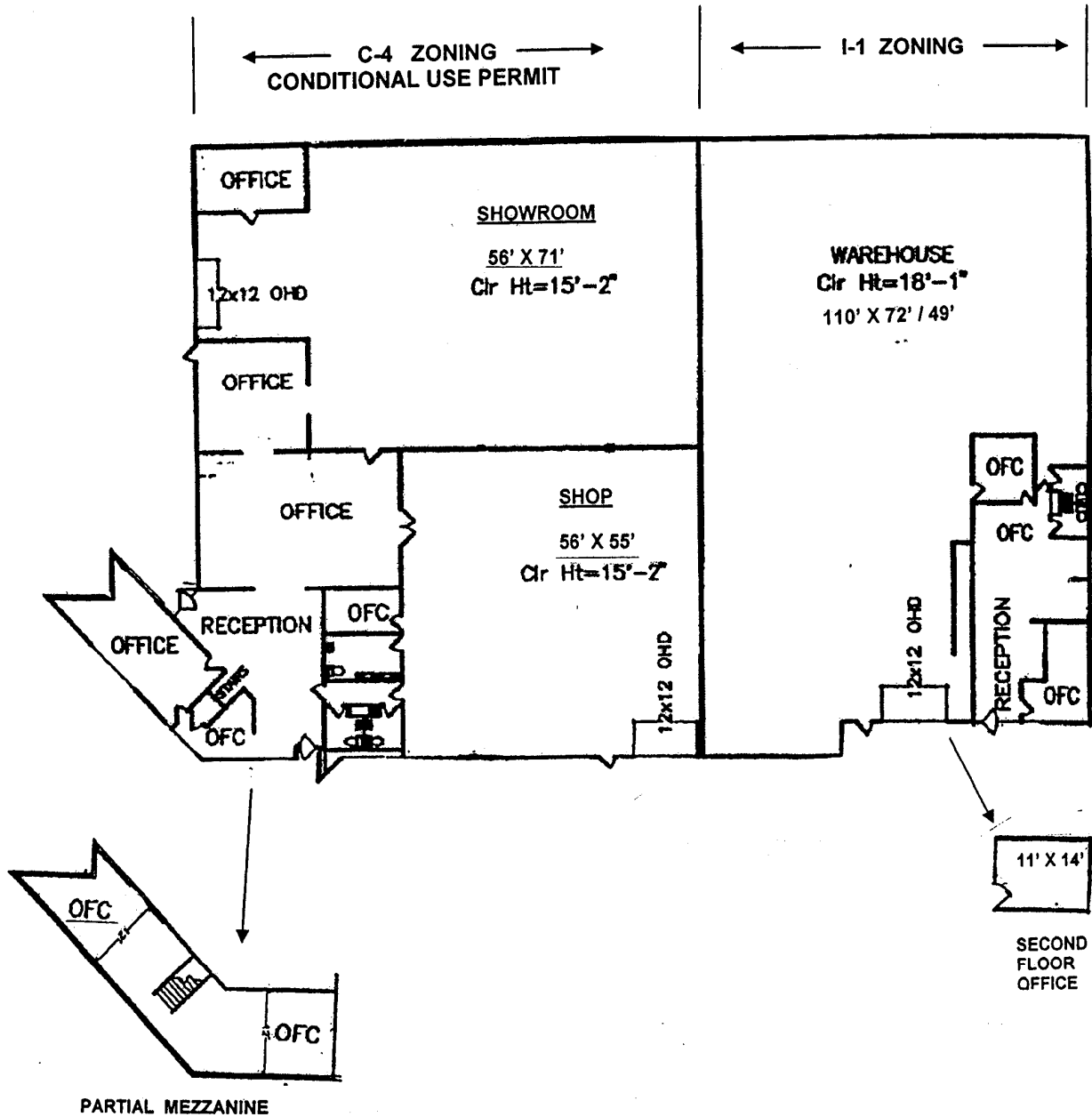

CONTACT:

DON SCHAEFER
 don@screaz.com

Cell: (602) 359.1599

7621 E. Gray Rd., Suite D
 Scottsdale, AZ 85260

Office: 480.998.5025
 Fax: 480.951.2493