

## FOR LEASE: INDUSTRIAL SPACE



### FEATURES

- LAYOUT: RECEPTION, 2 OFFICES, CONFERENCE ROOM, BULL PEN/OPEN WORK AREA, STORAGE ROOM, RESTROOM AND EVAP-COOLED WAREHOUSE WITH 12' CLEAR HEIGHT.
- SPRINKLERS: FULLY
- LOCATION: SOUTH OF REDFIELD ROAD, EAST OF SCOTTSDALE ROAD
- ZONING: CITY OF SCOTTSDALE I-1

### Available:

Suite(s) B1 +/-2,006 sf  
Office/Warehouse

### Lease Rate:

\$0.80/sf  
Industrial Gross

*To see our other properties  
follow this link*

<http://www.screaz.com/>

## Gray Road Center

7621 E. Gray Road  
Scottsdale, AZ 85260



### CONTACT:

**ERIC SCHAEFER**  
eric@screaz.com

Cell: (602) 525-0713

**7621 E. Gray Rd., Suite D**  
**Scottsdale, AZ 85260**

**Office: 480.998.5025**  
**Fax: 480.951.2493**

# FOR LEASE: INDUSTRIAL SPACE FLOOR PLAN



**7621 E. Gray Road**  
**Scottsdale, AZ 85260**

**Suite(s)**  
**B1**

**Size**  
**+/- 2,006 sf**

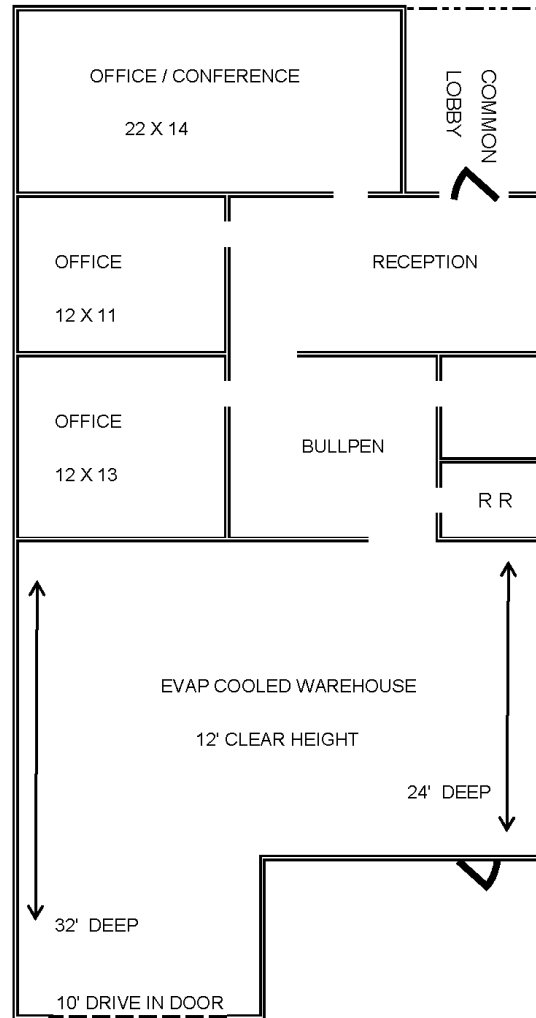

**CONTACT:**

**ERIC SCHAEFER**  
eric@screaz.com

Cell: (602) 525-0713

**7621 E. Gray Rd., Suite D**  
**Scottsdale, AZ 85260**

**Office: 480.998.5025**  
**Fax: 480.951.2493**