

OFFICE SPACE
AVAILABLE FOR LEASE

ARROWHEAD PROFESSIONAL CENTER SUITE A11 - 13 LOCATED AT:

18001 N. 79TH AVENUE, GLENDALE, AZ 85308



All rights reserved. Use Subject to License/Copyright | Map Legend

This map is informational only. No representation is made or warranty given as to its content. User assumes all risk of use. MapQuest and its suppliers assume no responsibility for any loss or delay resulting from such use.



SIZE +\ -2,592 S.F.

**OPEN FLOOR PLAN; EXCELLENT FOR
TENANT NEEDING BULLPEN SPACE,
SHOWROOM, OR MINIMAL INDIVIDUAL
OFFICES. FORMERLY A PHYSICAL
THERAPY PRACTICE.**

(See attached floor plan)

FOR MORE INFORMATION CONTACT

DON SCHAEFER: don@screaz.com

ERIC SCHAEFER: eric@screaz.com

14626 N. 78th Way, Bldg A
Scottsdale, AZ 85260
Office: 480.998.5025
Fax: 480.951.2493

18001 N. 79TH AVENUE
SUITE(S) # A 11 -- 13 @ +/- 2,592 S.F.

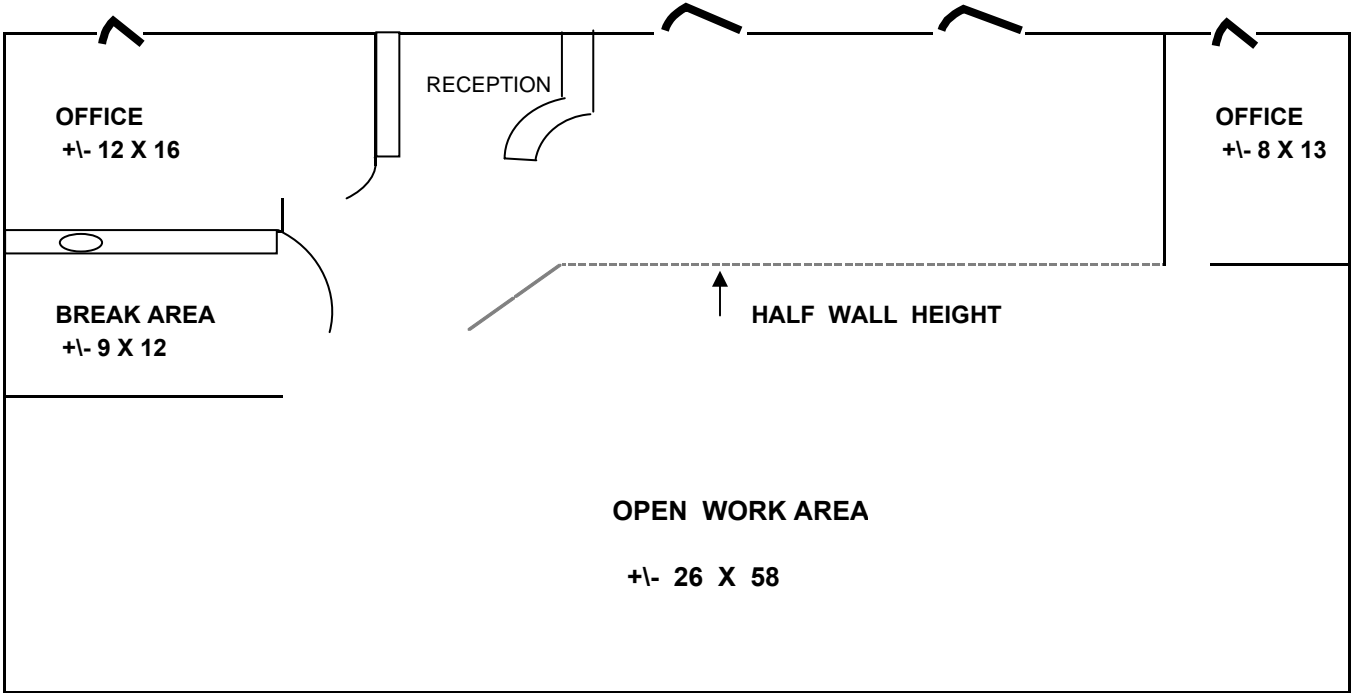

●● NOTE THAT RECEPTION DESK AND CABINETS ARE BUILT IN'S

NOT TO SCALE

ALL DIMENSIONS ARE APPROXIMATE